

EXISTING BUILDINGS 1:3000

The role of the 2 existing buildings had to be re-evaluated. Both structures were stripped from their function and have lost their sense of direction. Both have to be refurbished and kept within sight from each other, so they are not isolated in the new configuration. Their visual link is an extension of the present connection of public spaces in the block structure ("Stepping Stones"). Wide open spaces are assigned to both buildings.

The actual main station will accommodate a museum about local history (horse tramway) and the former station building shall be harboured by a market-hall, in which it will perform as a delicacy house.

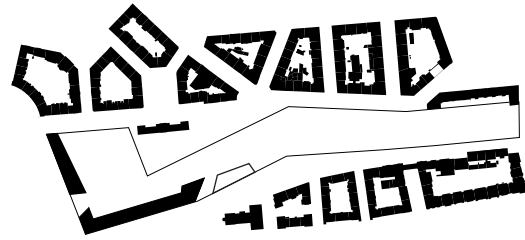

CASTLE WALL 1:6000

Walled city: the "housing walls" have three specialties: they define space on the outside. Milady Horákové will remain as an important street and the visible delineating of the district creates a comfort zone for noise and speed. Living within the wall gives you a vantage point to oversee the land, and in this case a splendid view of the castle. The wall also binds the urban space to the district.

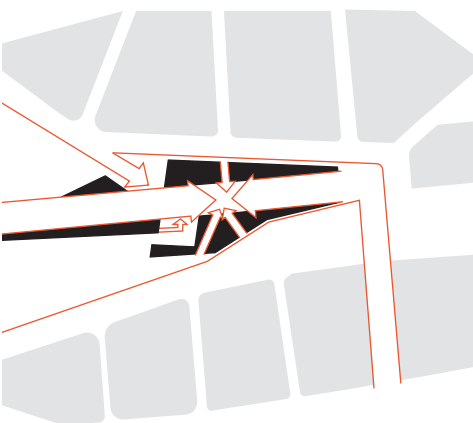
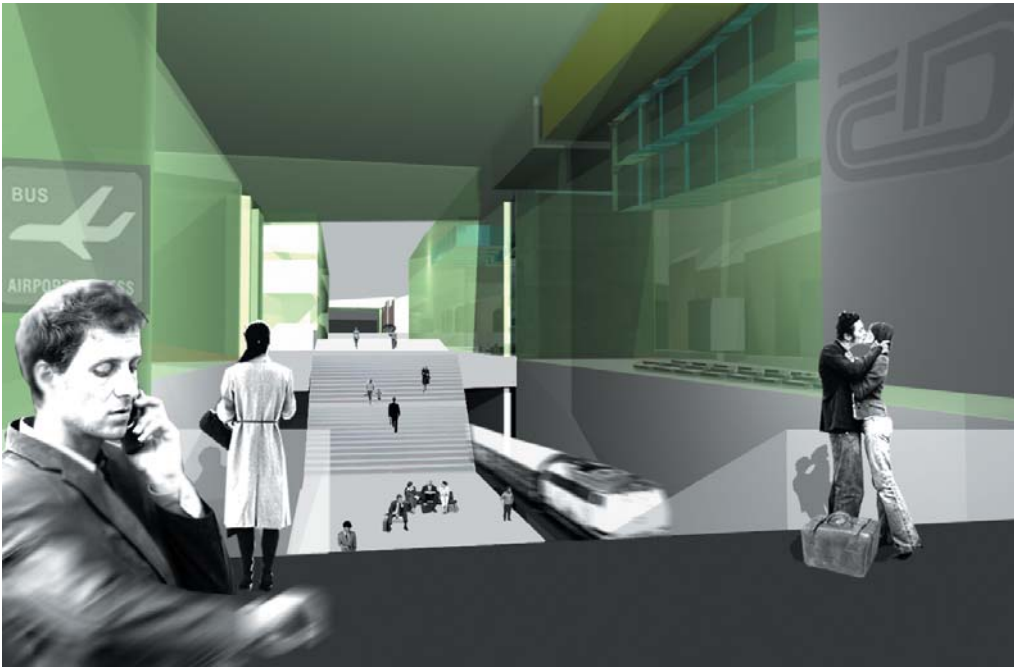

STATION 1:3000

"Harmonious big bang". The urban space is directed towards the train station main hall. The topographic differences are solved by terraces stepping from the main plaza (+28 m) down to the tracks. By stepping down deep into the fabric, the built structure will gain an unexpected scale. The station forecourt (24,5 m) is marked by the collision of the surrounding movements to a central space. The meeting of this flows, result in a cluster of buildings collected under one roof. Continuing from to the station's forecourt (24,5 m), the user descends all the way down to the platform (17 m), where he can enter the train.

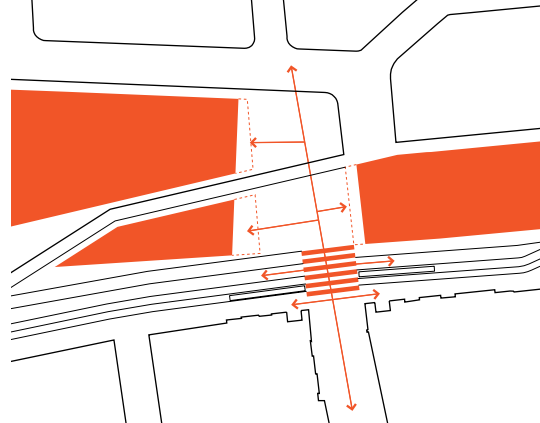

CROSSWALK 1:1500

All public transport facilities face the main north-south pedestrian connection. This axis is a connection of local movement coming from Dejvice shopping street (from the north) and the tourists, who have just visited the "Belvedere" mansion (from the south). The Milady Horákové street is split at this intersection, to create a median ("Dorfanger"), which on the one hand produces an entrance to the neighborhood and on the other hand reduces the Milady Horákové street as a barrier. The crosswalk is seen as a continuation of the 'Bahnhofsvorplatz' and offers direct access to both trams and a bus terminal. The bus terminal will handle local and regional bus traffic and will get a special stop for the Express bus from the airport so that tourists that now only transfer at Dejvicka metro station get involved in our location.

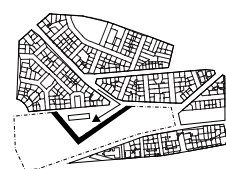
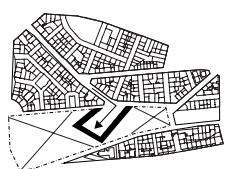
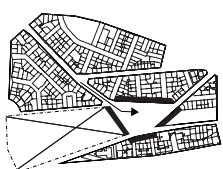

MARKET PLACE

Redirection square: The Dejvicka shopping street has no defined end. We use that to our advantage and redirect the circulation into the site. The introduced course grows wider, the further it progresses into the area, finally transforming into the main plaza. It also enables the former train station to become the focal point from a fresh approach. The market place has a clearly defined scenery and can work as platform for various activities from individual amusement to large-scale events.